

D. Programming Parameters:

MAX pressure value

1. Press and hold **MENU** for 2 seconds entering menu mode.
2. Press **▲** and **▼** to scroll to the Max parameter " **MAX** ".
3. If you want to read the max value, press **SET** key, LCD displays the value. If you don't want to read the value, press **▼** go to the next parameter MIN " **MIN** ".
4. When LCD displays the max value, If you want to clear this value, then press and hold **SET** for 2 seconds, the value will flashing and then stop to "0.0". The max value have been cleared and go to the next parameter MIN " **MIN** ".

MIN pressure value

1. Press and hold **MENU** for 2 seconds entering menu mode.
2. Press **▲** and **▼** to scroll to the MIN parameter " **MIN** ".
3. If you want to read the min value, press **SET** key, LCD displays the value. If you don't want to read the value, press **▼** go to the next parameter UNIT " **UNIT** ".
4. When LCD displays the min value, If you want to clear this value, then press and hold **SET** for 2 seconds, the value will flashing and then stop to "0.0". The min value have been cleared and go to the next parameter UNIT " **UNIT** ".

UNIT engineering unit

1. Press and hold **MENU** for 2 seconds entering menu mode.
2. Press **▲** and **▼** to scroll to the UNIT parameter " **UNIT** ".
3. If you want to read the unit, press **SET** key, the set unit appears. If you don't want to modify the unit, press **▼** go to the next parameter BACK " **BACK** ". If you want to modify the unit, press **▲** to scroll and select the unit you desired. And then press and hold **SET** for 2 seconds, the LCD will flashing. The new unit set well after stop flashing, then go to the next parameter BACK " **BACK** ".

BACK back light remain ON

1. Press and hold **MENU** for 2 seconds entering menu mode.
2. Press **▲** and **▼** to scroll to the BACK parameter " **BACK** ".

SET

return to the measure mode. If you want to modify the time, press **▲** to scroll and select the unit you desired. (There are 5, 10, 30 and 00 for option. "00" means the back light will be always on.) Then press and hold **SET** for 2 seconds, the value will flashing, the new value set well after stop flashing. Then return to measure mode.

Dimension Size

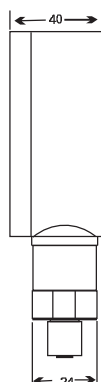
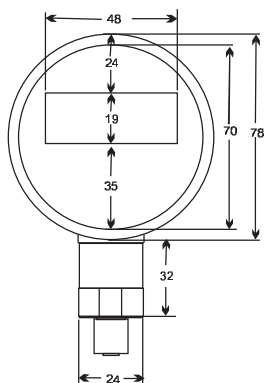

YOTO Electric Co.,LTD
3rd Floor, No.25 Building, Sicong Industrial Area
Xiaolan Town, Zhonshan Guangdong China



Tel: 86-760-22112809
Fax: 86-760-22104808
Email: sales@yotochn.net